

# TOK-G DIAL INDICATOR TORQUE WRENCHES

Easy to read dial indicator. Well suited for inspection and general maintenance service.



TOK-G (with peak indicator)



## FEATURES

- Oval design with comfort rubber grip reduces strain.
- Easily readable for inspections.
- Useful for general tightening work.
- Accuracy :  $\pm 3\%$  of indicated value over the full range

## USING A TOK WRENCH

- (1) Turn the dial cap and set the indicator to 0.
  - (2) Mount a socket on the square drive.
  - (3) Tighten until the indicator points to the desired torque.
- \* When using a peak indicator wrench, set it to 0 before tightening.

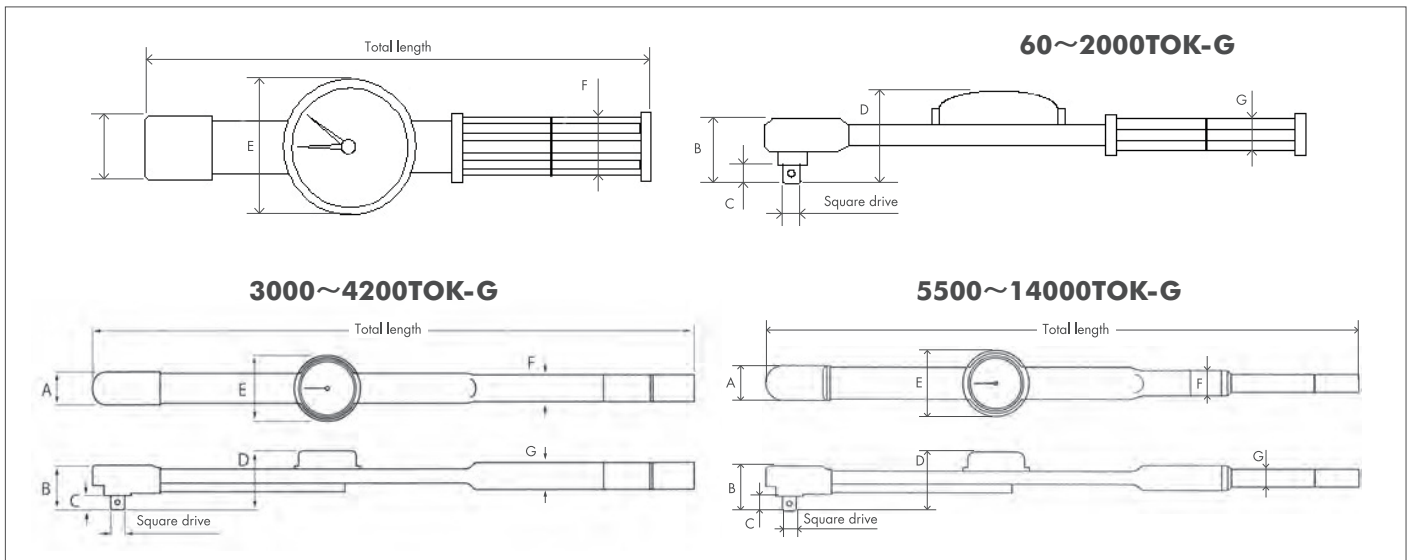

\* 14000TOK-G and N1400TOK-G do not have the rubber head.

Model (kgf·cm/kgf·m)	Range (CW/CCW) kgf·cm/kgf·m	Increment	Model (N·m)	Range (CW/CCW) N·m	Increment	Square drive mm	Total length mm	Dimensions (mm)							Weight kg
								Head			Body				
								A	B	C	D	E	F	G	
60TOK-G	6~60	1 kgf·cm	N 6TOK-G	0.6~6	0.1	6.35 (1/4")	260	35	38.5	7.5	58	90	37	21.5	0.5
120TOK-G	10~120	2	N 12TOK-G	1~12	0.2										
300TOK-G	50~300	5	N 30TOK-G	5~30	0.5										
500TOK-G	50~500	5	N 50TOK-G	5~50	0.5	9.53 (3/8")	323	35	43	11	60	90	37	21.5	0.61
700TOK-G	100~700	10	N 70TOK-G	10~70	1										
1400TOK-G	200~1,400	20	N 140TOK-G	20~140	2	12.7 (1/2")	463	39	49	14	65	90	41	22.5	0.87
2000TOK-G	200~2,000	20	N 200TOK-G	20~200	2										
3000TOK-G	3~30	0.5 kgf·m	N 300TOK-G	30~300	5	19.05 (3/4")	682	41	55	20	77	90	37	21.5	1.6
4200TOK-G	4~42	1	N 420TOK-G	40~420	10										
5500TOK-G	5~55	1	N 550TOK-G	50~550	10										
7000TOK-G	7~70	1	N 700TOK-G	70~700	10										
8500TOK-G	10~85	1	N 850TOK-G	100~850	10										
10000TOK-G	10~100	2	N 1000TOK-G	100~1,000	20										
14000TOK-G	20~140	2	N 1400TOK-G	200~1,400	20										
						25.4 (1")	1,280	54	64	85	93	90	41	22.5	0.87
							1,384	58	72	93	90	41	22.5	0.87	
							1,484	66	74	27	94	90	41	22.5	0.87
							1,696								